

Lead teacher/adult to call us when bus is on the access road on +643 307 6315

Group coordinator to meet bus at drop zone and to hand out passes to lead teacher/adult.



Once checked in, find an area where the group will be based (not in the café) and take the students there to leave their bags etc. Get them to use the bathroom. **Ensure all jackets and pants are on, and passes are in the jacket pocket before going to rentals.**

If hiring clothing- please get these fitted first before rentals.

Please see second page for directions.



Our Schools & Groups Co-ordinator will come and get you, to take you to rentals to be fitted with your gear at the allocated time.

Collect boots, then put shoes in the box with your school's name on it. Collect skis or snowboard and helmet and wrist guards before heading outside.

Helmets are mandatory for all kids and supervising adults.



Head up the stairs to the Snowsports area and look for the big green school group flag.

Enjoy your lesson!

Teacher/adult- Make sure the students know where to go once the lesson is over, as they are now your responsibility again.



When it's time to leave, please insure to head back to rentals and **return all the gear you collected in the morning.**

If you need your pass again, teachers we advise you collect in all the school passes and we can keep them for you for your next visit.

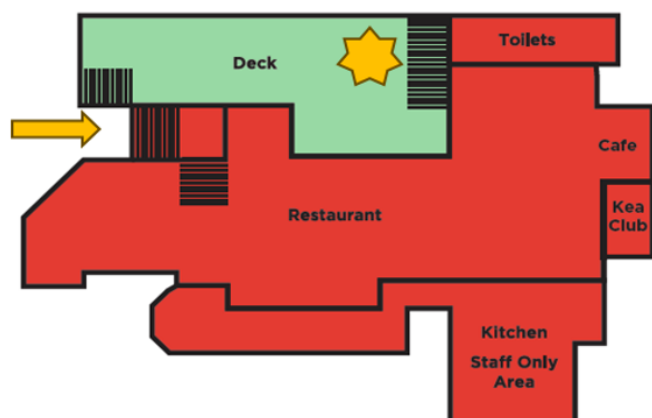

LEVEL 3

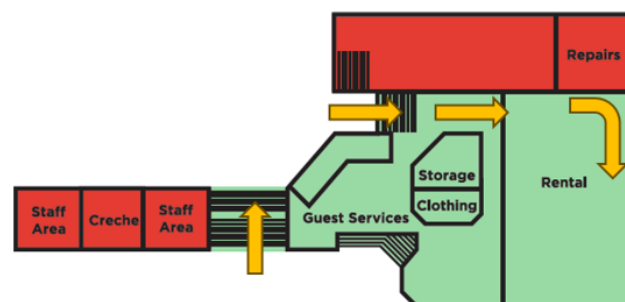

LEVEL 2

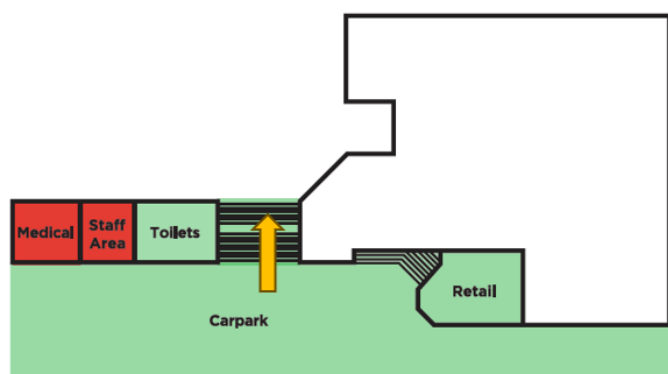

GROUND LEVEL

School Group Directions for arrival

- **Ground Level-** On arrival please head up the stairs between the toilets outside and the back of guest service until you are up and out on to the snow.
- **Level 3-** Then head up on to the deck to drop any bags off in the cubby holes.
- **Level 2-** Head back down the stairs towards rentals, head all the way past all poles and turn right at the end.
- You will then see benches on the back wall and a box with the school's name on- to store boots in.
- The rental team will then help you fit any gear that is needed.
- Head back through rentals the same way back out to snowsports for the lesson.